



# presidential

## CONSUMABLES

Edition 1



**CATTANI**

air technology



presidential  
dental | medical | veterinary

1800 PRESIDENTAL  
(1800 773 743)  
[info@presidential.com.au](mailto:info@presidential.com.au)  
[presidential.com.au](http://presidential.com.au)  
[/PresidentialAustralia](https://www.facebook.com/PresidentialAustralia)



# Contents

Page 3	<b>Euronda Consumables</b>
Page 6	<b>Bio Hygiene</b>
Page 9	<b>Acteon Riskontrol Disposable Syringe Tips</b>
Page 10	<b>Zepf Instruments</b>
Page 16	<b>Cattani Consumables</b>
Page 17	<b>Metasys Suction &amp; Statim Parts</b>
Page 18	<b>A-dec Chair Consumables</b>
Page 19	<b>A-dec Suction Consumables</b>
Page 20	<b>A-dec Chair/Stool Upholstery/Booster Seats</b>
Page 21	<b>A-dec Upholstery Colours</b>
Page 22	<b>Lisa Sterilisation Consumables</b>
Page 23	<b>W&amp;H Handpiece Maintenance</b>
Page 24	<b>W&amp;H Assistina Adaptor System</b>
Page 25	<b>W&amp;H Surgical Implant Tubings</b>
Page 26	<b>Relative Analgesia Clearview Scavenger Hoods</b>
Page 27	<b>Satelec Scalers &amp; Tips</b>
Page 30	<b>Satelec Scaler Modules &amp; Tip Kits</b>
Page 31	<b>EMS Scalers, Handpieces &amp; Tips</b>
Page 33	<b>Acteon AIR-N-GO Easy Prophylaxis</b>

**Euronda®**

**a|dec**  
reliablecreativesolutions

**BIO  
HYGIENE**

**CATTANI**  
air technology

**METASYS**

**STATIM**  
Cassette Sterilizers

**W&H**

**GETINGE**  
GETINGE GROUP

**ACTEON**

**EMS+**

**HELMUT ZEPF**  
MEDIZINTECHNIK GMBH

## Kit Monoart® 4

20% OFF  
WHILE STOCKS  
LAST



RRP ~~\$110.00~~

**\$88.00** per kit/  
1700 pieces

EU-225100XX

### Colours



### Packaging

500 Monoart® Towel Up!  
500 Monoart® EM15 Saliva ejector  
500 Monoart® Plastic cup  
200 Monoart® Face mask Protection 3

## Monoart® Bandana



**\$36.00** each

EU-2620XX

### Colours



### Packaging

single pack

## Monoart® Aspirator Tips



**\$29.00** per carton/  
10 pieces

**EM19 Evo** EU-2292000X

**\$29.00** per carton/  
10 pieces

**EM21 Evo** EU-2292001X

### Colours



### Packaging

EM19 Evo  
Connection diameter: 16 mm  
Length: 114 mm

EM21 Evo  
Connection diameter: 16 mm  
Length: 129 mm

Box of 10 pieces

Box of 10 pieces



- 1** Basic treatment ANTI-SCRATCH protects against scratches and abrasions  
\*K Anti-scratch treatment.

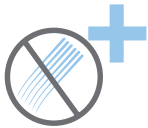

- 3** ANTI-SCRATCH PLUS treatment  
Constitutes a barrier against surface damage, it protects against scratches and abrasions. It is certified according to the requirement of EN166 "K".



- 2** Basic treatment ANTI-FOG that prevents the formation of condensation.  
\*N Anti-fog treatment.

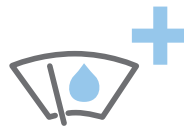

- 4** ANTI-FOG PLUS treatment  
It's a permanent treatment that prevents the formation of condensation. It is certified according to the requirement of EN166 "N".



- 5** UDC Univet Double Coating  
The revolutionary coating created through UDC technology provides to your eyewear superior resistance from scratches and fogging for outstanding performance in any working condition. Deposition of coatings in separate processes on the surfaces of the lens:  
- exclusive anti-fog coating inside the lens  
- multilayer scratch-resistant coating outside the lens. Both treatments are permanent and assure the product has high superior performance as per EN 166 standards. This technology is expressed in Monoart® Stretch Orange glasses.



- 6** SOFTPAD technology  
SoftPad is a patented terminal that has been added to the arm of the eyewear to offer comfort and protection. Thanks to the innovative use of materials and a meticulous design, the ergonomics of these glasses reach a new level of comfort, providing perfect stability to the safety glasses and full adaptability to the face of the user. In addition to the length adjustment in 3 positions, the SoftPad system has a further tilting movement that allows the device to fit perfectly to the user's head. The SoftPad system is supplied with the Monoart® Cube glasses Monoart® Cube Orange/Smoked glasses and Monoart® Stretch glasses.

## Eyewear marking

Added to personal protective equipments (PPE) the marking guarantees respect of current safety regulations. Required by the law, the marking is added both on the lens, to identify scale number, manufacturer, optical class, mechanical resistance and optional requirements, and on the frame to identify manufacturer, reference normative and mechanical resistance.

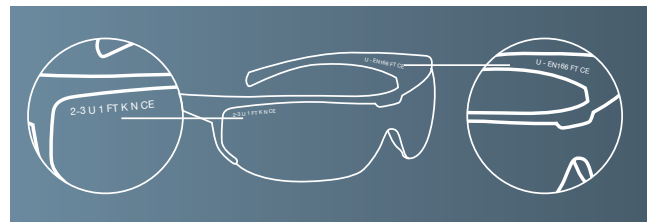

## European Normatives

EN 166 Personal eye-protection - Specifications / EN 167 Personal eye-protection  
- Optical test methods EN 170 Personal eye-protection - Ultraviolet filters.  
Transmittance requirements and recommended use

## Lens marking identification

2-3	U	1	FT	KN*	CE
Scale number (n.code+ shade)	Manufacturer	Optical class	Mechanical resistance	Optional requirement	

## Frame marking identification

U	EN 166	FT	CE
Manufacturer	Standard	Mechanical resistance	

Euronda is the exclusive distributor of **UNIVET** products in the dental field.

## Monoart® Protective Eyewear



Monoart® Spheric Glasses

**\$21.00** per unit

EU-261050



Monoart® Ultra Light Glasses

**\$21.00** per unit

EU-261002



NEW



Monoart® Evolution Glasses

**\$27.00** per unit

EU-261005



Monoart® Evolution Orange Glasses

**\$29.00** per unit

EU-261102



NEW

Monoart® Cube Glasses

**\$29.00** per unit

EU-261010



NEW

Monoart® Cube Orange Glasses

**\$31.00** per unit

EU-261011



NEW

Monoart® Baby Orange Glasses

**\$21.00** per unit

EU-261090



NEW

Monoart® Stretch Glasses

**\$29.00** per unit

EU-261030







## BIO HYGIENE

If a surface is not clean it's not Bio Hygiene

ASK US FOR A FREE TRIAL

### Bevisto W1 - Acidic

**No aldehydes – No phenols**

Concentrated aspiration system cleaner,  
Does not foam,  
Particularly protective to materials.  
Dual pH system, W1 + W2, weekly change.  
5% - dosage- Standard economy  
[5 Litres concentrate convert to 100 Litres  
ready for use solution, 50 x 2 Litre treatments.]

**TGA - Medical Device Included Class 1**  
**CE - MADE IN GERMANY**  
**REACH Compliant**

A dual pH  
system is  
more effective  
than a single  
pH cleaning  
system.



**\$74.75**



**JUST  
\$1.49 PER  
DOSE**

► Art. No BH002 - 5 litre jerry can

**\$28.55**



**JUST  
\$2.82 PER  
DOSE**

► Art. No BH001 - 1 litre dosage bottle

### Bevisto W2 - Alkaline

**No aldehydes – No phenols**

Concentrated Effective cleaning agent for  
aspiration systems,  
Does not foam  
Dual pH system, W2 + W1, weekly change.  
Particularly protective to materials.  
Very economical – 2%-  
[ 5 Litres concentrate convert to 250 Litres  
ready for use solution ,125 x 2 Litre treat-  
ments.]

**TGA - Medical Device Included Class 1**  
**CE - MADE IN GERMANY**  
**REACH Compliant**



**\$112.15**



**JUST  
\$0.89 PER  
DOSE**

► Art. No 3116 - 5 litre jerry can

**\$32.95**



**JUST  
\$1.31 PER  
DOSE**

► Art. No 3110 - 1 litre dosage bottle



ASK US FOR A FREE TRIAL

## BevistoCryl

### No aldehydes – No phenols

Universal cleaner for use on alcohol sensitive surfaces, Such as plastics, Perspex, leather and all hard surfaces. Ready for use on medical devices, equipment in clinical areas, between treatments and surgical procedures. Dispensed via foam and or Bio Hygiene Wipes.



**TGA Regulation: You CANNOT use a hospital grade disinfectant on medical devices.**

**TGA - Medical Device Included Class 1  
CE - MADE IN GERMANY  
REACH Compliant**



**\$61.55**



**JUST  
\$0.90 PER  
PUMP**

► Art. No 2040 - 5 litre jerry can

**\$24.15**



**JUST  
\$1.80 PER  
PUMP**

► Art. No 2041 - 1 litre dosage bottle

## BevistoCryl Dispenser

### Foam Spray Dispenser

Pumps out a foam which, unlike a spray, does not get air borne and is a much more economical alternative with less wastage.

Foam is much more economical than a spray.

Foam formulation contains micro bubbles enabling access into small and difficult to reach spaces.

Use in conjunction with **BevistoCryl 5 Litre and 1 Litre plastic bottles.**



**\$9.85**



**260  
PUMPS OF  
FOAM**

► Art. No BH018 - Foam Spray Dispenser



## BIO HYGIENE

If a surface is not clean it's not Bio Hygiene

ASK US FOR A FREE TRIAL

### Bio Hygiene Wipes

Made of non woven dry reel to be used with cleaning solutions.  
Maximum absorption and release of solutions.  
Special foil protection per reel of 250 wipes,  
Size: 17 cm x 26 cm, 45 gsm spunlace.

Can be used in conjunction with foam dispenser or pre-moistened with **BevistoCryl** (add 1.5 Litres of **BevistoCryl** to **BioHygiene Wipes** bucket).

Dispenser bucket  
1 reel



**\$37.35**

JUST  
\$0.14 PER  
WIPE

► Art. No BH016 - 250 wipes plastic bucket

### Bio Hygiene Wipe Refills

Made of non woven dry reel to be used with cleaning solutions.  
Maximum absorption and release of solutions.  
Special foil protection per reel of 250 wipes,  
Size: 17 cm x 26 cm, 45 gsm spunlace.

Refills : 4 reels per carton.



**\$84.65**

JUST  
\$0.08 PER  
WIPE

► Art. No BH017 - 250 wipes reels x 4



## Bevisto-Instrumental

### No aldehydes – No phenols

Concentrated Instrument Cleaner for medical and surgical instruments, e.g. general and rotary precision instruments, rubber polishers, invasive instruments such as endoscopes. Includes corrosion inhibitors and can be used in ultrasonic cleaners or Standard soaking trays.

Contains quarternary ammonium compounds. Ref. MSDS

#### Times Of Exposure - Conversion Rate

1% - 60 minutes  
2% - 30 minutes  
4% - 15 minutes

**TGA - Medical Device Included Class 1**  
**CE - MADE IN GERMANY**  
**REACH Compliant**



## BevistoSurface

### This product is pH neutral. No aldehydes – No phenols

Cleaning concentrate pH 7.5 for wiping and mopping surfaces. 5 Litres at 1% convert to 500 Litres ready for use solution. Suitable for soaking objects and for areas with a high dirt load. Contains didecyldimethylammoniumchloride Non-ionic tensides, synergistic additives, auxiliary agents, Complexing agents and scents.

**TGA - Medical Device Included Class 1**  
**CE - MADE IN GERMANY**  
**REACH Compliant**



## Art by RisKontrol®

The system that improves and guarantees infection control and can be used on a wide range of triplex syringe tips.

- Non-sterile disposable tips for air/water syringes
- Available in 5 colours / 5 aromas
- Box of 250 tips



SA-201703 Aniseed



SA-201700 Mint



SA-201702 Liquorice



SA-201701 Mandarin



SA-201704 Blackcurrant

**TIP  
PRICE  
BOX 250**

**\$93**



### Adaptors

Adaptors are available for most dental units on the market including:

- W&H
- Kavo
- DCI
- Planmeca
- Sirona
- Belmont



**ADAPTOR  
PRICE**

**\$180.50**



## For Diagnostic

**Total Diagnostic Package**

**\$1,339.70**

**6 x Tweezers, London College**  
Code 22.011.03

**\$22.25<sub>ea</sub>**



**12 x BIONIK Single Handle w/ Reducer**  
Code 26.194.08

**\$33.00<sub>ea</sub>**



**6 x Sickie Probe, Interchangeable**  
Code 24.099.23

**\$14.70<sub>ea</sub>**



**4 x Williams Perio Probe Interchangeable**  
Code 24.454.05

**\$38.00<sub>ea</sub>**



**12 x Mouth Mirrors, Interchangeable**  
Code 24.061.22

**\$47.50<sub>ea</sub>**



## For Periodontology

**Total Periodontology Package**

**\$1,323.00**

*Zepf BIONIK Gracey Curettes are Colour Coded for all Quadrants - see right for details*

**Incisors/Canines**

GRA 1/2  
GRA 1/2  
GRA 1/2



**Premolars/Molars**

GRA 7/8 buccal  
GRA 9/10 buccal  
GRA 11/12 buccal

GRA 13/14 distal  
GRA 15/16 mesial  
GRA 17/18 distal



**3 x BIONIK Curette, Gracey 5/6**  
Code 24.203.05G

**\$73.50<sub>ea</sub>**



**3 x BIONIK Curette, Gracey 7/8**  
Code 24.205.07G

**\$73.50<sub>ea</sub>**



**3 x BIONIK Curette, Gracey 11/12**  
Code 24.204.11G

**\$73.50<sub>ea</sub>**



**3 x BIONIK Curette, Gracey 13/14**  
Code 24.207.13G

**\$73.50<sub>ea</sub>**



**3 x BIONIK Scaler, H6/H7**  
Code 24.208.06H

**\$73.50<sub>ea</sub>**



**3 x BIONIK Scaler, 204S**  
Code 24.208.04S

**\$73.50<sub>ea</sub>**



## For Conservation

**Total Conservation Package**

**See over page**

**1 x Spatula #1 1.5mm small**  
Code 26.120.10Ti

**\$96.00<sub>ea</sub>**



**1 x Spatula #2 2.8mm large**  
Code 26.120.11Ti

**\$96.00<sub>ea</sub>**



**1 x Spatula #1 2.2mm, Burnisher 1.5mm**  
Code 26.120.20Ti

**\$96.00<sub>ea</sub>**



**1 x Spatula #2 2.4mm, Burnisher 1.9mm**  
Code 26.120.21Ti

**\$96.00<sub>ea</sub>**



**1 x Condenser 1.6mm small, 2.5mm large**  
Code 26.120.30Ti

**\$96.00<sub>ea</sub>**



**1 x Plugger 1.8mm small, 2.2mm large**  
Code 26.120.31Ti

**\$96.00<sub>ea</sub>**



## For Conservation

**Total Conservation Package**

**\$2,285.40**

**1 x Plugger 1.7mm small, 1.7mm small**  
Code 26.120.40Ti

**\$96.00<sub>ea</sub>**



**1 x Spatula Combination 1.7mm**  
Code 26.120.50Ti

**\$96.00<sub>ea</sub>**



**1 x Cement Spatula 4.5mm small**  
Code 26.130.01

**\$25.90<sub>ea</sub>**



**2 x Excavators 127/128 2.0mm**  
Code 24.708.27

**\$31.75<sub>ea</sub>**



**2 x Excavators 19 2.0mm**  
Code 24.733.19

**\$31.75<sub>ea</sub>**



**2 x Carving Instrument Hollenback #3 small**  
Code 28.130.00

**\$36.70<sub>ea</sub>**



**1 x Imp. Tray Upper B0 W55mm x L39mm**  
Code 28.601.00

**\$38.00<sub>ea</sub>**



**1 x Imp. Tray Upper B1 W65mm x L52mm**  
Code 28.601.01

**\$38.00<sub>ea</sub>**

**1 x Imp. Tray Upper B2 W71mm x L60mm**  
Code 28.601.02

**\$38.00<sub>ea</sub>**

**1 x Imp. Tray Upper B3 W73mm x L63mm**  
Code 28.601.03

**\$38.00<sub>ea</sub>**

**1 x Imp. Tray Upper B4 W80mm x L73mm**  
Code 28.601.04

**\$38.00<sub>ea</sub>**

**1 x Imp. Tray Lower B0 W61mm x L44mm**  
Code 28.606.00

**\$38.00<sub>ea</sub>**



**1 x Imp. Tray Lower B1 W72mm x L51mm**  
Code 28.606.01

**\$38.00<sub>ea</sub>**

**1 x Imp. Tray Lower B2 W78mm x L54mm**  
Code 28.606.02

**\$38.00<sub>ea</sub>**

**1 x Imp. Tray Lower B3 W82mm x L58mm**  
Code 28.606.03

**\$38.00<sub>ea</sub>**

**1 x Imp. Tray Lower B4 W83mm x L65mm**  
Code 28.606.04

**\$38.00<sub>ea</sub>**

**1 x Impression Modelling Knife**  
Code 28.130.00

**\$36.70<sub>ea</sub>**



**2 x Tofflemire Matrix Retainer**  
Code 19.060.00

**\$71.85<sub>ea</sub>**



**2 x Articulating Paper Forceps**  
Code 22.101.15

**\$68.85<sub>ea</sub>**



**1 x Rubber Dam Frame 10cm x 9.5cm**  
Code 19.125.00

**\$96.00<sub>ea</sub>**

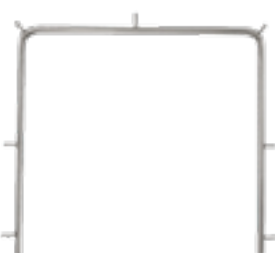

**1 x Rubber Dam Forceps Ivory**  
Code 19.037.01

**\$163.95<sub>ea</sub>**



**1 x Rubber Dam Punch Ainsworth**  
Code 19.010.00

**\$333.05<sub>ea</sub>**



## For Extraction

Total Extraction  
Package

See over page

**1 x Forceps, Xcision, Eng Ash 2\*  
Upper Incisors & Eye Teeth**  
Code 12.002.00Z

**\$196.75<sub>ea</sub>**



**1 x Forceps, Xcision, Eng Ash 33A  
Lower Incisors, Canines & Roots**  
Code 12.033.01Z

**\$216.35<sub>ea</sub>**



**1 x Forceps, Xcision, Eng Ash 35\*  
Upper Premolars Special Beaks**  
Code 12.035.00Z

**\$235.80<sub>ea</sub>**



**1 x Forceps, Xcision, Eng Ash 13\*  
Lower Premolars**  
Code 12.013.00Z

**\$216.35<sub>ea</sub>**



**1 x Forceps, Xcision, Eng Ash 17\*  
Upper Right Molars**  
Code 12.017.00Z

**\$196.75<sub>ea</sub>**



**1 x Forceps, Xcision, Eng Ash 18\*  
Upper Left Molars**  
Code 12.018.00Z

**\$196.75<sub>ea</sub>**



**1 x Forceps, Xcision, Eng Ash 73\*  
Lower Molars Better Access**  
Code 12.073.01Z

**\$216.35<sub>ea</sub>**



**1 x Forceps, Xcision, Eng Ash 51A\*  
Upper Jaw Roots**  
Code 12.051.15Z

**\$259.40<sub>ea</sub>**



Prefer different  
Forcep types?  
Various Forcep  
types available.  
Call us for options  
1800 773 743

**1 x Forceps, Xcision, Eng Ash 45Z\*  
Lower Jaw Roots**  
Code 12.045.15

**\$230.40<sub>ea</sub>**



**1 x X Tool, Straight 2.5mm Upper**  
Code 17.007.01

**\$139.60<sub>ea</sub>**



**1 x X Tool, Straight 4.5mm Upper**  
Code 17.007.02

**\$139.60<sub>ea</sub>**



**1 x X Tool, Curved 2.5mm Lower**  
Code 17.007.03

**\$139.60<sub>ea</sub>**



**1 x X Tool Curved 4.5mm Lower**  
Code 17.007.04

**\$139.60<sub>ea</sub>**



**1 x X Desmo Tool, Spade 4.0mm  
Fibres**  
Code 17.007.05

**\$139.60<sub>ea</sub>**



**1 x Lucas Scraper, 2.5m Double Ended**  
Code 41.855.01Z

**\$118.20<sub>ea</sub>**



**1 x Periotome Combo P2/P3**  
Code 26.182.23

**\$184.65<sub>ea</sub>**



**1 x Periotome Combo P4/Spoon 3.0mm**  
Code 26.182.24

**\$184.65<sub>ea</sub>**







## For Extraction

Total Extraction Package

**\$3,766.20**

**1 x Root Elevator, Straight 2.0mm**

Code 17.001.10

**\$94.50<sub>ea</sub>**



**1 x Root Elevator, Straight 3.0mm**

Code 17.001.11

**\$94.50<sub>ea</sub>**



**1 x Root Elevator, Straight 4.0mm**

Code 17.001.12

**\$94.50<sub>ea</sub>**



**1 x Root Elevator, Straight 5.0mm**

Code 17.001.13

**\$94.50<sub>ea</sub>**



**1 x Heidbrink Root Sprint Elevator**

**2.0mm**

Code 17.055.02

**\$104.40<sub>ea</sub>**



**1 x Heidbrink Root Sprint Elevator**

**2.5mm**

Code 17.055.03

**\$104.40<sub>ea</sub>**



## For Surgical

Total Surgical Package

**\$855.15**

**2 x Surgical Scissors Iris Curved 11.5cm**

Code 46.051.11

**\$92.10<sub>ea</sub>**



**2 x Surgical Scissors Iris Straight 11.5cm**

Code 46.050.11

**\$89.95**



**1 x Needle Holder Straight**

**17.5mm TC**

Code 41.252.15TC

**\$281.30<sub>ea</sub>**



**1 x Haemostatic Forceps Kelly 14cm**

Code 23.098.14

**\$85.45<sub>ea</sub>**



**1 x Scalpel Holder Round**

**for 10-15 Blades**

Code 46.007.00

**\$90.20<sub>ea</sub>**



**1 x Scalpel Blades # 15.**

**Packed 100**

Code 46.014.15

**\$34.10<sub>ea</sub>**



## COMBINED INSTRUMENT SETS:

- Diagnostic
- Periodontology
- Conservation
- Extraction
- Surgical

as listed on pages 10-13

**SAVE \$302.74**

**RRP \$8,222.74**

**PACKAGE PRICE**

**\$7,920\***

## For Conservation

**Total Conservation Package**

**\$395.00**

### Addition of the CompoSMOOTH Brush & Application Insert Set

The CompoSMOOTH, a special silicon brush, allows an easy adaption and modelling of the composite surface before polymerisation. Even 'sticky' composite can be adapted in an optimal way. The perfect surface morphology is created by only slight pressure.

Set includes:

Code 19.200.00 CompoSMOOTH Brush Holder

**\$194.60**

Code 19.201.11 SoftApplication Insert – tapered – Set 12

**\$66.90**

Code 19.201.21 SoftApplication Insert – flat – Set 12

**\$66.90**

Code 19.201.31 SoftApplication Inser – pointed – Set 12

**\$66.90**



**CompoSMOOTH**  
THE SURFACE IS THE KEY...

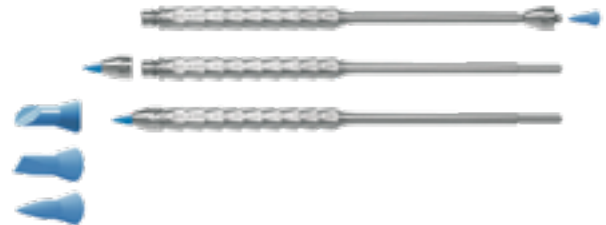

## For Extraction

### Upgrade of Extration Forceps to RoBa edition

With the patented design, RoBa is the advancement of conventional extracting forceps with the advantages of a tapered deep grip. The modified beaks fit exactly on the teeth which ensures a maximum grip on the appliance. The new beaks are available for all figures in the upper and lower jaw.



The billow grind claws radially into the teeth and avoids a 'riding' between the tooth crown and the inner contour of the beak.



Concavely elaborated inner contours of the forceps beak fit in the convex tooth contour. With deep grip in the alveolus on the neck of the tooth or crown, RoBa ensures a parallel and maximum grip.

**ZEPF**  
**roba**  
EDITION  
PATENTED

*This upgrade changes those Xcision Forceps marked \* to RoBa type*

**\$369**

## For Extraction

### Addition of the Benex II Extraction System

In modern dentistry, Implantology following extraction is favoured.

Benex II provides gentle & simple extraction of roots over the whole mouth.

Damage to soft tissue and the surrounding bone is minimised.

Due to the longitudinal extraction method, Benex II provides the optimal base for directimplantation. It is also a valuable aid for retarded implantation after extraction

**Benex II**



Set includes:

Code 12.303.00 Benex II Set – Basic type

**\$3,988**

12.302.00

## Addition of the BIONIK Mirror Retractor

The The Revolutionary BIONIK Mirror and Mouth Retractor provides ease of retraction and viewing access never before possible.

Code 24.062.30 24mm Retractor/Mirror Width

OR

Code 24.062.31 27mm Retractor/Mirror Width



**\$68.20<sub>ea</sub>**

## Addition of Wisdom Teeth Extraction Forcep Set

Kit Upgrade Price

**\$499**

### Xcision Forceps Ash 67 for Upper Wisdom Teeth

Code 12.067.95Z



**\$68.20<sub>ea</sub>**

### Xcision Forceps Ask 79 for Lower Wisdom Teeth

Code 12.079.95Z



**\$68.20<sub>ea</sub>**

• German-Made  
• Hand-Crafted Instruments  
• Highest Quality!

## Addition of the Universal Forceps

No surgery should be without the Zepf Universal Forceps.

Able to be used for securely grasping provisional plastic items, bridges, nerve instruments, impacted matrices, attaching inlays, setting interdental wedges etc. The Tungsten Carbide jaws provide secure grip.

Code 19.281.15TC



**\$400**

## Addition of Contrast PA Probe Inserts

Zepf Contrast PA Probes are made of flexible plastic to adapt optimally to the anatomy of the pocket depth.

Sterilisable, the tips are reusable until they bend or the graduation colour fades.

For use with the Zepf BIONIK handles included with instrument set.

Different graduation versions available.



**\$204**

## Addition of Crown Spreading Pliers

The Helmut Zepf Crowning Spreading Pliers are designed for spreading Crowns without pressure on the root or neighbouring tooth.

Sturdy, and a spring handle to hold the instrument securely in place.

Code 19.277.01Z



**\$346**

## Addition of the Universal Finishing Clamp Set



These innovative holding instruments for finishing strips of all types. The instrument is designed for ergonomic functionality to contribute for the significant easing of work involving finishing strips and other applications.

Code 23-120-12

**\$216**

 <p><b>Eco Jet 1 Spray for surfaces</b> M040745</p> <div>\$30.80 ea</div>	 <p><b>Pulse Cleaner for Suction</b> C040720</p> <div>\$99.00 ea</div>	 <p><b>Pulijet Gental 1L</b> M060970</p> <div>1+ \$51.70 ea</div> <div>4+ \$45.40 ea</div>	 <p><b>Antifoaming Disinfectant Tablets - Box 50 tablets</b> M040825</p> <div>\$115.50 box</div>
 <p><b>Lubrijet Lubricant - Box of 4</b> M040727</p> <div>\$33.00 ea</div>	 <p><b>Adaptor</b> C150000 for saliva ejector</p> <div>1+ \$19.80 ea</div> <div>3+ \$18.80 ea</div>	 <p><b>Reducer</b> C160000 connects 11mm tips to 17mm terminal</p> <div>1+ \$5.50 ea</div> <div>3+ \$5.25 ea</div>	 <p><b>Turbo Smart Filter</b> C201544</p> <div>\$191.40 ea</div>
 <p><b>Inline filter for Turbo Jet 1 &amp; 2</b> C004000</p> <div>\$181.50 ea</div>	 <p><b>Filter for 0011B tip supports &amp; Aspijet</b> C113000</p> <div>\$36.30 ea</div>	 <p><b>Filter for 0055 hanger</b> C551400</p> <div>\$36.30 ea</div>	 <p><b>Air filter for mazi canister</b> C120280</p> <div>\$12.10 ea</div>
 <p><b>Terminal - 17mm (grey)</b> C11014G</p> <div>\$56.10 ea</div>	 <p><b>Terminal 11mm (black)</b> C11015G</p> <div>\$56.10 ea</div>	 <p><b>Suction Tip CT9 (pkt 3)</b></p> <div>1+ \$33.00 ea</div> <div>3+ \$31.30 ea</div>	 <p><b>Suction Tip CT11 (pkt 3)</b></p> <div>1+ \$33.00 ea</div> <div>3+ \$31.30 ea</div>
 <p><b>Suction Tip CT17 (pkt 3)</b></p> <div>1+ \$33.00 ea</div> <div>3+ \$31.30 ea</div>	 <p><b>Suction Tip CT20 (pkt 3)</b></p> <div>1+ \$33.00 ea</div> <div>3+ \$31.35 ea</div>	 <p><b>Suction Tip CT21 (pkt 3)</b></p> <div>1+ \$33.00 ea</div> <div>3+ \$31.35 ea</div>	 <p><b>Suction Tip CT22 (pkt 3)</b></p> <div>1+ \$33.00 ea</div> <div>3+ \$31.35 ea</div>
 <p><b>Cleaning Brushes</b> C18 (Small) C19 (Large)</p> <div>\$9.90 ea</div> <div>\$9.90 ea</div>	 <p><b>Funnel Spittoon</b> C040502</p> <div>\$25.30 ea</div>	 <p><b>Suction Hose &amp; Terminal</b> Available in 3 colours 11mm 16mm</p> <div>\$150.70 ea</div> <div>\$150.70 ea</div>	 <p><b>Spiral Tubing</b> (black, grey or white) 11, 14 or 17mm</p> <div>\$36.30/m</div>  <p><b>Silicone Tubing</b> (black, grey or white) 11, 14 or 17mm</p> <div>\$61.60/m</div>



## Metasys Suction Consumables



### Green and Clean CL - STARTER KIT:

\$198.00 ea

MS-60010301  
contains:  
-1 x 500ml Bottle (for 100 dosed applications)  
-1 x Compact Dispenser unit



### Green and Clean CL - REFILL SET A:

\$181.50 ea

MS-60010302  
contains:  
-2 x 500ml Bottles (for 200 dosed applications)



### Green and Clean CL - REFILL SET B:

\$99.00 ea

MS-60010303  
contains:  
-1 x 500ml Bottles (for 100 dosed applications)



### Metasys Exchange Cannister:

\$117.65 ea

MS-55021805

**Suction Line  
Cleaning &  
Disinfection  
from just \$1.30  
per day!**



## Statim Parts



### Cassette Seal:

Statim 2000: 01-100028S  
Statim 5000: 01-101649S

\$162.85 ea

\$248.60 ea



### Thermal Printer Paper:

\$107.95 ea

01-101657A



### Vista Cool, auto-drainage system:

9A586001 Vista Cool Single System  
9A586002 Vista Cool Double System

\$1,372

\$1,777

**No need to  
drain  
bottles  
daily!**

**STATIM**  
Cassette Sterilizers



**S Class  
Sterilisers  
from  
\$10,221**

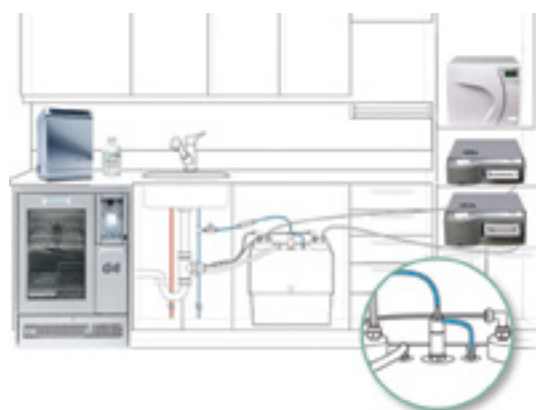

**Ask us about further  
Statim parts and pricing**

## A-dec Chair Consumables

	<b>Standard Syringe Tip</b>	Pack of 5	Pack of 25
	23-0872-01 (pack of 5) 23-0872-02 (pack of 25)	\$90.50 ea	\$389.00 ea
	<b>Syringe Tip Retainer Non-locking Kit</b>	1+	3+
	23-1112-00	\$44.50 ea	\$42.30 ea
	<b>A-dec Triplex Handpiece</b>	1+	3+
	Traditional 23-1011-00 Continental 23-1096-00	\$417.50 ea \$417.50 ea	\$396.65 ea \$396.65 ea
	<b>A-dec Triplex Syringe Orings</b>	1+	3+
	Small pkt 10 - 034-003-01 Large pkt 10 - 035-062-01	\$30.50 \$12.00	\$29.00 \$11.40
	<b>A-dec ICX Waterline Treatment Tablets</b>	1+	3+
	0.7 Litre - 90-1064-01 2.0 Litre - 90-1065-01	\$88.50 ea \$132.00 ea	\$84.10 ea \$125.40 ea
	<b>A-dec Replacement Water Bottles</b>	1+	3+
	0.7 Litre -14-0416-00 2.0L for A-dec 300 & 500, white - 14-0468-01 2.0L for A-dec 300 & 500, surf - 14-0468-00 2.0L for A-dec 200, white - 14-0486-00	\$66.50 ea \$307.00 ea \$307.00 ea \$195.00 ea	\$63.20 ea \$291.65 ea \$291.65 ea \$185.25 ea
	<b>A-dec Adjustment Keys</b>	1+	3+
	500 Chair (pkt 4) - 38-1808-01 300 Chair individual - 38-1823-00 1040 Chair Individual - 98-0867-00 Performer individual - 027-057-00	\$81.00 \$13.00 ea \$21.50 ea \$26.50 ea	\$76.95 \$12.35 ea \$20.45 ea \$25.20 ea
	<b>Silicone Lubricant - Tube</b>	1+	3+
	Pkt 6 - 98-1120-00 (Satchels) 1 x tube - 120g - RY421515	\$49.00 ea \$52.80	\$46.55ea \$50.20
	<b>Stainless Steel Trays</b>	1+	3+
	Standard 241 x 343mm - 043-001-00 Large 295 x 432mm - 043-006-00	\$117.00 ea \$245.00 ea	\$111.15 ea \$232.75 ea
	<b>Washable Tray Pads</b>	1+	3+
	39-0790-02 (pkt 5)	\$44.50	\$42.30
	<b>A-dec Overhead Light Globe</b>	1+	3+
	6300 Globe 95W, 17V - 041-709-00 Performer Globe - 041-513-00	\$64.50 ea \$58.50 ea	\$61.30 ea \$55.60 ea
	<b>A-dec Overhead Light Shield</b>	1+	3+
	LED Light Shield - 90-1343-00 Performer - 28-1166-00 A-dec 200 - 28-1991-00 A-dec 300 - 28-2031-00 A-dec 500/6300 - 28-0503-01	\$216.00 ea \$87.50 ea \$195.00 ea \$208.00 ea \$174.00 ea	\$205.20 ea \$83.15 ea \$185.25 ea \$197.60 ea \$165.30 ea

## A-dec Suction Consumables

### A-dec HVE Suction Parts

Product Code Price

HVE Assembly (complete)	12-1257-00	\$387.50 ea
HVE Barrel Assembly only	12-1116-00	\$114.50 ea
Barrel O-rings (pkt 10)	034-019-01	\$30.50
Spring Clip (pkt 5)	12-1109-01	\$53.00
Tailpiece Connector	12-1121-00	\$41.00 ea
Base O-ring (pkt 10)	034-018-02	\$30.50
Smooth HVE 11mm Hosing (7ft)	024-144-04	\$67.35 ea
"EasyFlex" 15mm tube w/ 15mm tailpieces (63") grey	12-1238-01	\$143.50 ea
"EasyFlex" 15mm tube w/ 15mm tailpieces (52") grey	11-1293-01	\$143.50 ea

### Autoclavable HVE Assembly with Large Bore 15mm 12.1257.00

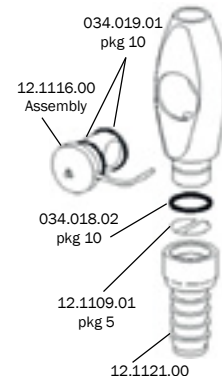

### A-dec Saliva Ejector Suction Parts

Product Code Price

Saliva Ejector Assembly (complete)	12-1258-00	\$200.00 ea
Barrel Assembly	12-1093-00	\$43.00 ea
Tip O-rings (pkt 10)	034-107-01	\$30.50
Optional Screen (pkt 10)	11-1235-01	\$45.00
Tailpiece	12-1088-00	\$41.50 ea
Smooth SE Hosing (7ft)	024-142-04	\$22.65/7ft
10mm tube w/ 10mm tailpieces (63") grey	11-1307-01	\$143.50 ea
10mm tube w/ 10mm tailpieces (52") grey	12-1232-01	\$143.50 ea

### Saliva Ejector Assembly without Tubing 12.1258.00

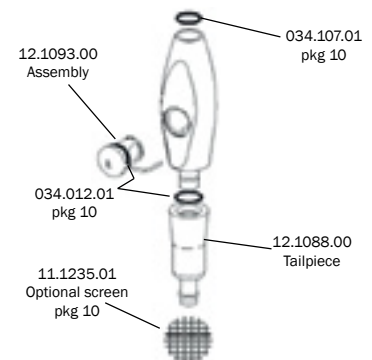

### A-dec Suction Consumables



**Screen Solid Trap**  
11-1191-01 - Pkt 10

1+	3+
\$27.00	\$25.65



**Screen Ellipse Solid Trap**  
11-1284-01 - Pkt 10

1+	3+
\$40.00	\$38.00



**Cuspidor Bowl Screen**  
Pkt 5 Surf colour - 75-0035-01  
Pkt 5 White colour - 75-0035-03

1+	3+
\$58.50	\$55.60
\$58.50	\$55.60



**Triple Vacuum Connector**  
A-dec 500 Surf - 77-0453-00  
A-dec 500 White - 77-0453-01  
Oring only - 030-035-02

1+	3+
\$40.00 ea	\$38.00 ea
\$40.00 ea	\$38.00 ea
\$18.00 ea	\$17.10 ea



**Vacuum Tower Cap**  
A-dec 500 Surf - 77-0254-01  
A-dec 500 White - 77-0254-03  
Oring only - 030-035-02

1+	3+
\$46.00 ea	\$43.70 ea
\$46.00 ea	\$43.70 ea
\$18.00 ea	\$17.10 ea



**Vacuum Brushes**  
1/2 inch - Pkt 6 049-001-01  
3/4 inch - Pkt 6 049-004-01

1+	3+
\$58.50	\$55.60
\$53.00	\$50.35



**Ask us about  
dual pH suction  
line cleaner for  
best results  
in infection  
control**

**Check out our  
online shopping for  
consumables at  
presidental.com.au**

**Accesss previous  
orders and save  
yourself time on  
routine orders  
placed.**

## Chair Upholstery Sets

200 Seamless	62-0699-00	\$2,075.00
200 Sewn	61-3810-00	\$4,035.00
300 Seamless (Version A)	62-0396-00	\$2,025.00
300 Sewn (Version A)	62-0677-00	\$4,035.00
300 Seamless (Version B)	62-0947-00	\$2,025.00
300 Sewn (Version B)	62-0956-00	\$4,035.00
400 Seamless with Knob headrest	62-0790-00	\$2,900.00
400 Seamless with Lever headrest	62-0874-00	\$2,900.00
400 Sewn with Knob headrest	62-0787-00	\$4,535.00
400 Sewn with Lever headrest	62-0872-00	\$4,535.00
500 Seamless	62-0165-00	\$3,075.00
500 Sewn	62-0171-00	\$4,820.00
1040 Seamless	61-2018-00	\$3,030.00
1040 Sewn	61-2600-00	\$4,750.00
Performer Seamless	61-2751-00	\$2,450.00
1011/1021 Seamless	61-1671-00	\$3,330.00

## Stool Casters

Surf (pkg 5)	65-1625-03	\$114.50
Grey (pkg 5)	65-1625-04	\$114.50



**421/1601**  
Doctor Stool



**422/1622**  
Assistant Stool



**521**  
Doctor Stool



**522**  
Assistant Stool

## Stool Upholstery Sets

421/1601 Doctor Stool	65-0212-00	\$505.00
422/1622 Assistant Stool	65-0235-00	\$795.00
521/522 Stool Upholstery (fits both)	65-1883-00	\$975.00

\*Note that upholstery listed above is for complete sets. Individual pieces are also available, please phone for a quote.



## Toe Board Covers

200 Seamless	61-1679-00	\$190.50
300 Seamless Ver. A	62-0676-00	\$190.50
300 Seamless Ver. B	62-0848-00	\$197.50
300 Sewn Ver. A	62-0685-00	\$190.50
300 Sewn Ver. B	62-0847-00	\$197.50
400 Seamless	62-0848-00	\$197.50
400 Sewn	62-0847-00	\$197.50
500 Seamless	62-0156-00	\$190.50
500 Sewn	62-0184-00	\$190.50
1040 Seamless	61-1679-00	\$190.50
1040 Sewn	61-2619-00	\$190.50
Performer Seamless	61-2619-00	\$190.50
1011/1021 Seamless	61-1679-00	\$190.50
1010/1015 Thick	61-1693-00	\$190.50
1010/1020 Tubular	61-1632-00	\$190.50

## Crescent Booster Seat for Child

Booster Seat Only - Blue	CR.DP81	\$319.00
Booster Seat Only - Pattern	CR.DP87	\$319.00
Booster Seat Only - Grey	CR.DP82	\$319.00
Booster Seat & Pillow Set - Blue	CR.DP81/51	\$396.00
Booster Seat & Pillow Set - Pattern	CR.DP87/55	\$396.00
Booster Seat & Pillow Set - Grey	CR.DP82/52	\$396.00



**A-dec 200**



**A-dec 300**



**A-dec 400**



**A-dec 500**



**A-dec Performer**



**A-dec 1040**



**A-dec 1011/1021**



## Sewn Upholstery

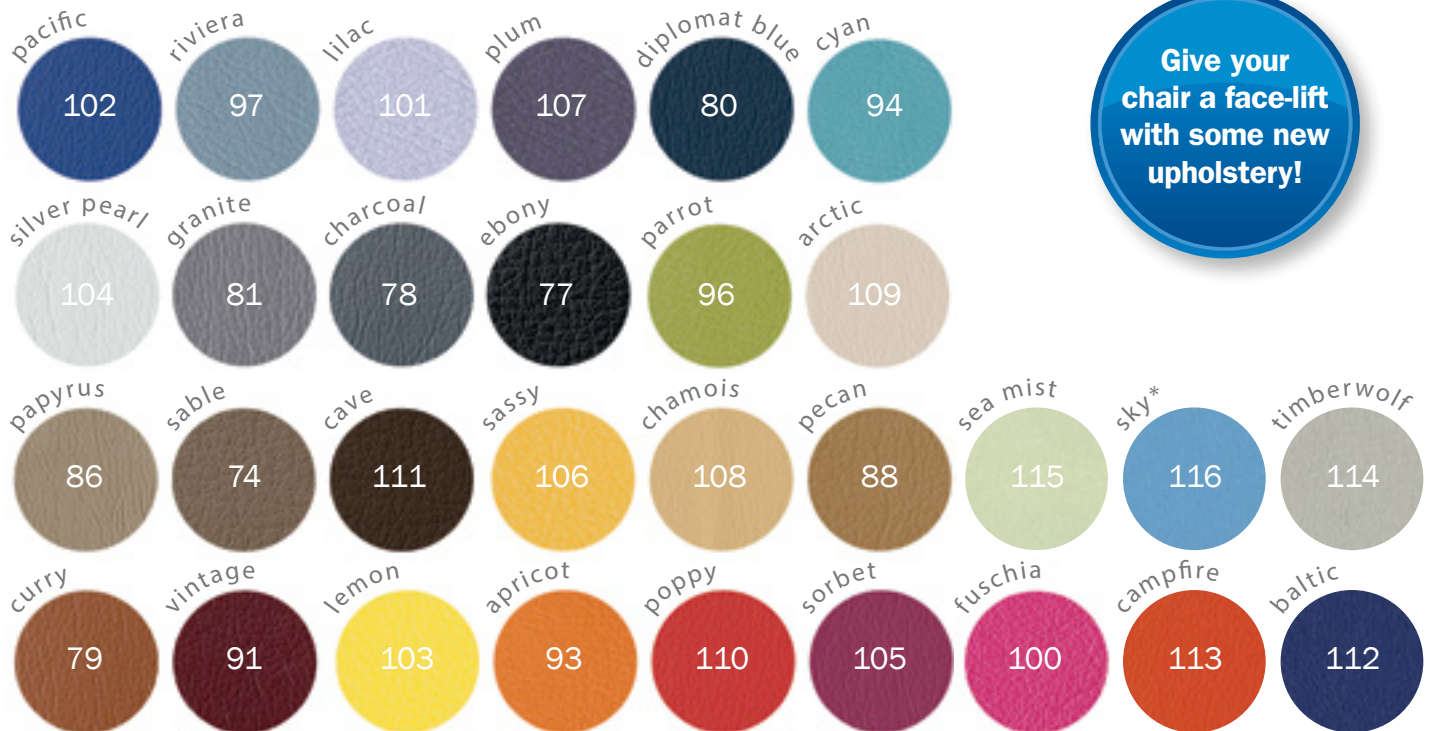

**Give your chair a face-lift with some new upholstery!**

## Seamless Upholstery



**30% off**  
selected upholstery colours\*

\*while stocks last

\* Final Stock available only

\*\* Additional colours available with special orders

## A-dec Upholstery Colours

Create the right treatment room environment with designer colours to match your style. Soft, luxurious sewn upholstery and smart, sleek seamless upholstery. Choose a palette to convey your unique vision.

Want to experiment with your favorites? Go to [presidential.com.au/inspireme](http://presidential.com.au/inspireme) and mix and match cabinet, countertop, floor, and wall colours to make your investment your very own.



from \$13,995



SEE PAGE 34-38 FOR  
STERILISATION EQUIPMENT

## W&H Lisa 500 Series Autoclave VA & FA

	<b>Bacteriological Filter</b>	1+	3+
	WH-W3224001	\$78.50 ea	\$74.60 ea
	<b>Dust Filter</b>	1+	3+
	WH-F3645020	\$41.00 ea	\$38.95 ea
	<b>Door Seal (Grey)</b>	1+	3+
	WH-F4605041	\$124.00 ea	\$117.80 ea
	<b>Aluminium Trays</b>	1+	3+
	(17L) WH-F5232040	\$81.00	\$76.95
	(22L) WH-F5232050	\$111.50 ea	\$105.95 ea
	*pricing is per tray		
	<b>MMC Card for Logger</b>	1+	3+
	WH-A801018X	\$186.50 ea	\$177.20 ea
	<b>Lisasafe Consumable Kit</b>	1+	3+
	WH-A8105000	\$170.50 ea	\$162.00 ea

## W&H Lisa MB Series Autoclave

	<b>Bacteriological Filter</b>	1+	3+
	WH-W3224001	\$78.50 ea	\$74.60 ea
	<b>Printer Accessories</b>	1+	3+
	Printer Ribbon ERC-09	\$29.40 ea	\$27.95 ea
	Printer Paper	\$3.00 ea	\$2.85 ea
	WH-A700140X		
	<b>Door Seal (Black)</b>	1+	3+
	WH-F4605031	\$113.50 ea	\$107.85 ea
	<b>Aluminium Trays</b>	1+	3+
	(17L) WH-F5232040	\$81.00 ea	\$76.95 ea
	(22L) WH-F5232050	\$111.50 ea	\$105.95 ea
	*pricing is per tray		
	<b>Lisa Log64</b>	1+	
	Change printer to data logger WH-19721114	\$1,225.00	

## Demineralisation Cartridges

	<b>W&amp;H Multidem C27 Resin Cartridge</b>	1+	3+
	WH-A812016X	\$585.00 ea	\$555.75 ea

## Incubators & Incubator Accessories

	<b>EZtest® 13 Well Indicator</b>	\$712.00 ea
	I-1410	
	<b>EZTest® Self Contained Biological Indicators for Steam Sterilisation</b>	\$111.40
	EZS5/25 (Pkt 25)	
	<b>Smart-Well Incubator Kit SWI-202</b>	\$3,267.00
	Includes: 1x Dual Temp 10 Well Incubator; 1x Record Printer; 1x Record Book	

## Autoclave Test Kits

### Helix Test Packs

	<b>W&amp;H Helix</b>	1+	3+
	WH-8002051 (pkt 250)	\$314.50	\$298.80
	<b>Euronda Helix</b>		
	EU-242005 (pkt 250)	\$238.00	\$226.10
	<b>Melag Helix</b>		
	MEL-01080	\$278.50	\$264.60

### Class 6 Strips

	<b>Browne TST Class 6</b>	1+	3+
	IN-33002015 (pkt 100)	\$33.45	\$31.80
	<b>Titem's Class 6 Emulators</b>		
	AUS-508 (pkt 250)	\$65.35	\$62.10
	<b>Meditrax Class 6 Emulators</b>		
	SBM-002 (pkt 400)	\$199.40 ea	\$189.45 ea

### Bowie & Dick Tests

	<b>Green Card Bowie &amp; Dick Test Indicators</b>	1+	3+
	PL254 (packets x 15 tests)	\$59.70	\$56.75









Did you know  
we service and  
validate LISA  
Sterilisers -  
from \$527

## W&H Spray Can

	<b>Service Oil</b>	1+	3+
	WH-MD-400	\$56.30 ea	\$53.50 ea
<b>Price Reduced!</b>			
	<b>Spray Cap</b>	1+	3+
	Chuck System WH-02036100	\$9.50 ea	\$9.00 ea
	<b>Spray Cap</b>	1+	3+
	WH-02229200	\$9.50 ea	\$9.00 ea
<b>For W&amp;H turbine handpieces and air motors with Roto Quick connection</b>			
	<b>Spray Cap</b>	1+	3+
	WH-02038200	\$9.50 ea	\$9.00 ea
<b>For contra-angle and straight handpieces with Roto Quick connection</b>			



## assistina 301

### Assistina 301

	<b>Oil and Cleaner Pack</b>	1+	3+
	WH-02680500-S	\$194.00 ea	\$184.30 ea
	<b>Service Oil only</b>	1+	3+
	WH-MD-500	\$126.50 ea	\$120.20 ea
	<b>Cleaning Solution only (1L)</b>	1+	3+
	WH-MC1000	\$68.00 ea	\$64.60 ea
	<b>Exhaust Filter</b>	1+	3+
	WH-02670500	\$105.00 ea	\$99.75 ea
	<b>Fleece Tray Liner</b>	1+	3+
	Pkt 20 WH-02694500	\$42.50	\$40.40
	Pkt 5 WH-02690300	\$17.00	\$16.15
	<b>Nose Cone O-rings</b>	1+	3+
	pkt 3 WH-02695700	\$9.75	\$9.30

## assistina 3X3

### Assistina 3X3

	<b>Service Oil</b>	1+	Pkt 4
	WH-06691500	\$59.50 ea	\$227.00 ea
	<b>Activefluid</b>	1+	Pkt 6
	WH-06691600	\$47.50 ea	\$272.50 ea
	<b>Nose Cone O-rings</b>	1+	3+
	pkt 3 WH-02695700	\$9.75	\$9.30

### Assistina TWIN

	<b>TWIN Care Set</b>	\$232.00
	(Includes: Cleaning Fluid, Service Oil, HEPA Filter) WH-07484000	

## assistina 3X3

**3x2 FROM \$6,225**

**3x3 FROM \$7,720**



## assistina 301

**FROM \$2,950**



## Adaptor for Contra-Angle and Straight Handpieces



**WH-02691000**

For Sirona T1 handpiece

\$307.50 ea



**WH-02693000**

For FG chuck system  
(W&H and Sirona)

\$149.50 ea



**WH-02671000**

For NSK contra-angles with  
removable heads

\$149.50 ea



**WH-02679000**

For NSK contra-angles with  
removable heads

\$171.00 ea



**WH-06257600**

For slow speed handpieces  
on Assistina 3x3 only

\$341.50 ea

assistina 301

assistina 3X3

**Ask us  
about annual  
servicing on  
your Steriliser  
or Assistina**

## Adaptor For Turbine Handpieces



**WH-02690400**

For all W&H products with Roto  
Quick system

\$283.00 ea



**WH-02692000**

For Sirona TS2 and TM1 handpieces

\$302.00 ea



**WH-04713200**

For turbine handpieces with  
Multiflex connection

\$157.00 ea



**WH-02083500**

For NSK and Borden turbines  
2 (3) hole connection

\$139.50 ea

**Interested in  
improving your  
steri-room  
workflow? Ask us  
about the latest  
options available**

## Base Adaptors



**WH-02685000**

Included in the assistina base kit,  
for turbine handpieces or adaptors  
with 4 hole connection (with or  
without light)

\$99.50 ea



**WH-02671500**

For NSK 4 hole connection

\$99.50 ea

**Buy an extra  
base adaptor  
and save time**

### Time Saving Hint...

If you have multiple brands of high speed (turbine) handpieces you can save time by purchasing a base adaptor for each coupling. This will enable you to switch between handpiece brands with ease.

**Ask us about  
Handpiece  
Servicing!**

Did you know that handpieces require regular servicing to maintain optimal performance? Just like the rest of your equipment, handpieces need to be on a maintenance schedule, and replaced every few years. If you are not getting optimal performance out of your handpieces, give us a call today and we can arrange to quote or assess your handpieces so that you won't have to put up with sub-performance any longer!





## Pump Tubing with Nipple



**WH-04013900** 1+ 3+  
(1 pcs) \$59.50 ea \$56.55 ea

## Pump Tubing with Nipple



**WH-04013900** 1+ 3+  
(1 pcs) \$59.50 ea \$56.55 ea

## Pump Tubing with Nipple



**WH-04013900** 1+ 3+  
(1 pcs) \$59.50 ea \$56.55 ea

## Pump Tubing with Nipple



**WH-04035100** 1+ 3+  
(1 pcs) \$65.50 ea \$62.30 ea

## Pump Tubing with Nipple



**WH-02800500** 1+ 3+  
(5 pcs) \$271.50 ea \$257.95 ea

## Pump Tubing



**WH-04014000** 1+ 3+  
(3 pcs, 85mm) \$20.00 ea \$19.00 ea

## Pump Tubing



**WH-04014000** 1+ 3+  
(3 pcs, 85mm) \$20.00 ea \$19.00 ea

## Pump Tubing



**WH-04014000** 1+ 3+  
(3 pcs, 85mm) \$20.00 ea \$19.00 ea

## Pump Tubing



**WH-04035200** 1+ 3+  
(3 pcs, 190mm) \$37.50 ea \$35.65 ea

## Pump Tubing



**WH-02801500** 1+ 3+  
(3 pcs, 85mm) \$30.50 ea \$29.00 ea

## Disposable Irrigation Tubing



**WH-00929300** 1+ 10+  
(10pcs, 2.2m) \$88.50 ea \$84.10 ea

## Disposable Irrigation Tubing



**WH-00929300** 1+ 10+  
(10pcs, 2.2m) \$88.50 ea \$84.10 ea  
**WH-00929400** 10+  
(10pcs, 3.8m) \$104.50 ea \$99.30 ea

## Disposable Irrigation Tubing



**WH-00929300** 1+ 10+  
(10pcs, 2.2m) \$88.50 ea \$84.10 ea

## Disposable Irrigation Tubing



**WH-00929300** 1+ 10+  
(10pcs, 2.2m) \$88.50 ea \$84.10 ea  
**WH-00929400** 10+  
(10pcs, 3.8m) \$104.50 ea \$99.30 ea

## Disposable Irrigation Tubing



**WH-00929300** 1+ 10+  
(10pcs, 2.2m) \$88.50 ea \$84.10 ea  
**WH-00929400** 10+  
(10pcs, 3.8m) \$104.50 ea \$99.30 ea

## Disposable Irrigation Tubing Set



**WH-04363600** 1+ 10+  
(6 pcs, 2.2m) \$138.50 ea \$131.60 ea

## Disposable Irrigation Tubing Set



**WH-04363600** 1+ 10+  
(6 pcs, 2.2m) \$138.50 ea \$131.60 ea  
**WH-04364100** 10+  
(6 pcs, 3.8m) \$163.50 ea \$155.35 ea

## Disposable Irrigation Tubing Set



**WH-04363600** 1+ 10+  
(6 pcs, 2.2m) \$138.50 ea \$131.60 ea

## Disposable Irrigation Tubing Set



**WH-04365300** 1+ 10+  
(6 pcs, 2.2m) \$138.50 ea \$131.60 ea  
**WH-04365100** 10+  
(6 pcs, 3.8m) \$163.50 ea \$155.35 ea

**SEE PAGE  
32-33  
EQUIPMENT  
SECTION FOR  
SURGICAL  
EQUIPMENT**

## Sterilisable Irrigation Tubing Set



**WH-04719400** 1+  
(1 pcs, 2.2m) \$186.00 ea

## Sterilisable Irrigation Tubing Set



**WH-04719400** 1+  
(1 pcs, 2.2m) \$186.00 ea

## Sterilisable Irrigation Tubing Set



**WH-04719400** 1+  
(1 pcs, 2.2m) \$186.00 ea

## Disposable Y-Switch



**WH-04366300** 1+  
(4 pcs, 2.2m) \$59.50 ea  
**WH-04364800** 10+  
(4 pcs, 3.8m) \$83.50 ea

**Buy in bulk  
and SAVE!**

**Ask us about  
Autoclave Servicing  
& Validation**



## Scavenging Hoods and Tubing Sets



### Axess Low Profile Nasal Hoods

The Axess low profile design provides unencumbered mouth access whilst its small lightweight scavenging tubing is easy to work around, enabling clinicians to deliver excellent efficient care to more patients.



Designed for the lightweight Axess autoclavable tubing set.

### Clearview Nasal Hoods

Accutron's Clearview Scavenging Hood System incorporate a double hood with a transparent outer hood, allowing the **doctor to monitor the patient's breathing** for increased safety.

Combined with scented hoods, Clearview combined with NO<sub>2</sub> reduces patient anxiety for treatment.



Available to fit existing Tubing Sets - see below for Adapter Kits.

## Nasal Hoods and Tubing Sets for Accutron and other Brand RA Systems

### Axess Low Profile Nasal Hoods



#### Single use Hoods

##### Small Size (Pedo)

Unscented  
Bubblegum Scent  
Mint Scent

#### Set of 24

**\$198**

Ref. AC.53037-9  
Ref. AC.53037-12  
Ref. AC.53037-16

##### Medium Size (Adult)

Unscented  
Bubblegum Scent  
Mint Scent

**\$198**

Ref. AC.53035-9  
Ref. AC.53035-12  
Ref. AC.53035-16

##### Large Size (Adult)

Unscented  
Bubblegum Scent  
Mint Scent

**\$198**

Ref. AC.53034-9  
Ref. AC.53034-12  
Ref. AC.53034-16

#### Axess Scavenging Tubing Set

Lightweight and Autoclavable, allows you to fit the Axess Hoods to any system type!

For tubing with Scavenging Control valve  
use with non-Accutron existing systems  
AC.53005 **\$418**

For tubing less Scavenging Control valve  
use with existing Accutron systems  
AC.53006 **\$352**

**Save 30% on Axess Tubing Set with your 1st Axess Hood Order!**

### Clearview Hoods



- Fits Accutron Scavenging Sets
- Fits Porter™ Scavenging Sets
- Fits Matrx™ Scavenging Sets\*

#### Single Use Hoods - Set of 12

##### Adult Size

Unscented  
Orange Scent  
Vanilla Scent  
Mint Scent

**\$108**

Ref. AC.33035-9  
Ref. AC.33035-10  
Ref. AC.33035-14  
Ref. AC.33035-16

##### Pedo Size

Orange Scent  
Strawberry Scent  
Bubblegum Scent  
Grape Scent

**\$108**

Ref. AC.33037-10  
Ref. AC.33037-16  
Ref. AC.33037-12  
Ref. AC.33037-17

Converter Kits for  
Porter™ & Matrx™  
Tubing Sets

**NO CHARGE**

#### For Clearview Hood

For Porter Tubing Set No Adapter Needed  
For Matrx Tubing Set Ref. AC.35360

#### For PIP+ Hood

For Porter Tubing Set Ref. AC.35000  
For Matrx Tubing Set Ref. AC.35000M  
For ANS Tubing Set Ref. AC.35325

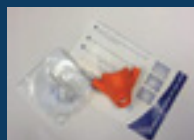

### PIP+ Hoods



- Fits Accutron PIP+ Tubing Sets
- Fits Porter™ Scavenging Sets\*
- Fits Matrx™ Scavenging Sets\*

#### Single Use Hoods - Set of 24

##### Large Size

Variety Set Ref. AC.33015-3  
Mint, Peach and Vanilla Scents

**\$198**

##### Medium Size

Variety Set 1 Ref. AC.33016-1  
Orange, Strawberry & Bubblegum Scents  
Variety Set 2 Ref. AC.33016-3  
Mint, Peach and Vanilla Scents

**\$187**

##### Small Size

Variety Set Ref. AC.33017-1  
Orange, Strawberry & Bubblegum Scents

**\$176**

### Autoclavable Hood

#### Multiple Use

##### Large Size

**\$209**  
Ref. AC.33018

##### Medium Size

**\$198**  
Ref. AC.33019

##### Small Size

**\$187**  
Ref. AC.33020



## Acteon Newtron Scaler Handpiece

SA-F12281

NEWTRON



FROM  
**\$970**

## Acteon Newtron LED Scaler Handpiece

SA-F12609

NEWTRON  
LED



FROM  
**\$1,351**

## Pure Newtron Slim Handpiece

SA-F12901

NEWTRON



FROM  
**\$1,102**

## Pure Newtron Slim B.LED HP with Blue Ring

SA-F12900

NEWTRON B.LED



FROM  
**\$1,527**

## Acteon Wrenches

### Acteon Torque Wrenches

\$116.00 ea



### Scaler Wrenches

SA-F81300 (Green)

\$47.80 ea

SA-F81301 (Yellow)

SA-F81302 (Blue)

SA-F81303 (Orange)



## Prophylaxis Scaling Tips



**N°1**  
F00246  
Universal

\$133.20 ea



**N°2**  
F00247  
High power

\$133.20 ea



**N°3**  
F00248  
Removing stains

\$133.20 ea



**10P**  
F00253  
Supra and sub-  
gingival <3 mm

\$133.20 ea



**10X**  
F00359  
Interproximal

\$133.20 ea



**10Z**  
F00254  
Subgingival

\$163.90 ea



**N°1S**  
F00245  
Supra and sub-  
gingival

\$163.90 ea

## Periodontic Tips



**H1**  
F00366  
Anterior teeth,  
diamond-coated

\$157.10 ea



**H2L**  
F00367  
Premolars & molars,  
left-angled

\$157.10 ea



**H2R**  
F00368  
Premolars & molars,  
right-angled

\$157.10 ea



**H3**  
F00369  
Anterior teeth,  
curette

\$157.10 ea



**H4L**  
F00114  
Premolars & molars,  
left-angled

\$297.10 ea



**H4R**  
F00115  
Premolars & molars,  
right-angled

\$297.10 ea



**P2L**  
F00090  
Narrow pockets  
debridement, left

\$426.85 ea



**P2R**  
F00091  
Narrow pockets  
debridement, right

\$426.85 ea



**TK1-1S**  
F01001  
Short probe

\$136.60 ea



**TK1-1L**  
F01004  
Long probe

\$136.60 ea



**TK2-1L**  
F02162  
Premolars & molars,  
left-angled

\$338.05 ea



**TK2-1R**  
F02161  
Premolars & molars,  
right-angled

\$338.05 ea

## PerioFine Tips



**PFU**  
F02170  
Universal

\$133.20 ea



**PFL**  
F02171  
Left-angled

\$133.20 ea



**PFR**  
F02172  
Right-angled

\$133.20 ea

## Endodontic Scaling Tips

			
<b>ET18D</b> F88017 Cavity access finishing	<b>ETBD</b> F88020 Exploration	<b>ET25S</b> F88021 Short Ti-Nb tip	<b>ET25</b> F88018 Ti-Nb tip
\$177.60 ea	\$177.60 ea	\$191.25 ea	\$191.25 ea
			
<b>ET25L</b> F88022 Long Ti-Nb tip	<b>ET20</b> F88011 Universal	<b>ETPR</b> F88019 Loosening	<b>ET40</b> F88012 Length 40 mm
\$191.25 ea	\$122.95 ea	\$160.50 ea	\$126.35 ea
			
<b>ET40D</b> F88014 Length 40 mm, diamond-coated	<b>ET20D</b> F88013 Length 20 mm, diamond-coated	<b>S04</b> F88009 Gutta Percha condenser	<b>IRR 20-21 (x4)</b> F43807 Ø 0.2 mm length 21 mm
\$136.60 ea	\$136.60 ea	\$133.20 ea	\$140.00
			
<b>IRR 20-25 (x4)</b> F43808 Ø 0.2 mm length 25 mm	<b>IRR 25-21 (x4)</b> F43805 Ø 0.25 mm length 21 mm	<b>IRR 25-25 (x4)</b> F43806 Ø 0.25 mm length 25 mm	<b>K15-25 (x4)</b> F43717 Ø 0.15 mm length 25 mm
\$140.00	\$140.00	\$140.00	\$58.05

## Implant Cleaning Tips

		
<b>PH1 (x4)</b> F00702 Anterior teeth	<b>PH2L (x4)</b> F00705 Premolars & molars, left-angled	<b>PH2R (x4)</b> F00706 Premolars & molars, right-angled
\$153.70	\$133.20	\$133.20

## Restorative Scaling Tips

		
<b>PMS1</b> F02254 Preparation of the dentin	<b>PMS2</b> F02255 Preparation/finishing	<b>PMS3</b> F02256 Finishing
\$191.25 ea	\$191.25 ea	\$133.20 ea
		
<b>PM1</b> F02250 Preparation of the dentin	<b>PM2</b> F02251 Preparation/finishing	<b>PM3</b> F02252 Finishing
\$191.25 ea	\$191.25 ea	\$133.20 ea
		
<b>PM4</b> F02253 Corono-radicular preparation, conical, diamond-coated 46 µm	<b>C20</b> F00113 Inlay/onlay condensation	<b>5AE</b> F00249 Loosening with spray
\$191.25 ea	\$146.85 ea	\$133.20 ea

## Conservative & Restorative Scaling Tips

			
<b>ET40</b> F88012 Length 40 mm	<b>ET40D</b> F88014 Length 40 mm, diamond-coated	<b>ET20D</b> F88013 Length 20 mm, diamond-coated	<b>S04</b> F88009 Gutta Percha condenser
\$126.35 ea	\$136.60 ea	\$136.60 ea	\$133.20 ea





## Surgical Endodontic Scaling Tips



**AS3D**  
F00065  
Length 3 mm  
Universal

\$160.50 ea



**AS6D**  
F00079  
Length 6 mm

\$160.50 ea



**AS9D**  
F00067  
Length 9 mm

\$160.50 ea



**ASLD**  
F00080  
Length 3 mm, left-angled (premolars)

\$160.50 ea



**ASRD**  
F00081  
Length 3 mm, right-angled (premolars)

\$160.50 ea



**P14D**  
F00106  
Universel

\$157.10 ea



**P15LD**  
F00107  
Left-angled

\$157.10 ea



**P15RD**  
F00108  
Right-angled

\$157.10 ea



**S12-70D**  
F00118  
70° Universal

\$157.10 ea

## Conservative & Restorative Scaling Tips



**EX1**  
F02040  
Occlusal surface

\$191.25 ea



**EX2**  
F02041  
Proximal surface

\$191.25 ea



**EX3**  
F02042  
Distal surface

\$191.25 ea



**EX-R**  
F02043  
45° to the right

\$191.25 ea



**EX-L**  
F02044  
45° to the left

\$191.25 ea

## Implant Protect Tips



**IP1**  
F02121  
Implant abutments and wide threads

\$293.70 ea



**IP2L**  
F02122  
Medium implant threads, left-angled

\$293.70 ea



**IP2R**  
F02123  
Medium implant threads, right-angled

\$293.70 ea



**IP3L**  
F02124  
Narrow implant threads, left-angled

\$293.70 ea



**IP3R**  
F02125  
Narrow implant threads, right-angled

\$293.70 ea

## Endodontics Tips



**K10-21 (x4)**  
F43710  
Ø 0.1/length 21 mm

\$58.05 ea



**K10-25 (x4)**  
F43712  
Ø 0.1/length 25 mm

\$58.05 ea



**K15-21 (x4)**  
F43715  
Ø 0.15/length 21 mm

\$58.05 ea



**K25-21 (x4)**  
F43725  
Ø 0.25/length 21 mm

\$58.05 ea



**K25-25 (x4)**  
F43727  
Ø 0.25/length 25 mm

\$58.05 ea



**K30-21 (x4)**  
F43730  
Ø 0.3/length 21 mm

\$58.05 ea



**K30-25 (x4)**  
F43732  
Ø 0.3/length 25 mm

\$58.05 ea

**HOW WORN ARE YOUR CURRENT SCALER TIPS? FOR OPTIMUM PERFORMANCE, AND TO PROTECT YOUR SCALER HANDPIECE THREADS, BE SURE TO REGULARLY REPLACE YOUR SCALER TIPS.**

## Newtron / Pure Newtron Module Kits

### Newtron Kit

SA-F55385

**\$2,435**

Kit consists of:

- SP Newtron (LED/Non-LED Newtron module + handpiece + 3 tips)

### Newtron LED Kit

SA-F55389

**\$3,420**

### Pure Newtron Slim B.LED Grey3 61"

SA-F55469

**\$3,880**

### Pure Newtron B.LED 81"

SA-F55470

**\$3,915**

### Pure Newtron Slim 81"

SA-F55472

**\$2,725**

### Pure Newtron Slim 61"

SA-F55471

**\$2,700**



**F.L.A.G for B.LED  
5 X 1.5ml**  
SA-F62200

**\$85.00**

**F.L.A.G for B.LED  
100ml**  
SA-F62203

**\$181**



## Satalec Scaler Tip Kits

### Scaling Kit (Prophylaxis)

SA-F00934

**\$471**



### Perio Kit

SA-F00936

**\$659**



### EndoSuccess Retreatment Kit

SA-F00737

**\$935**



### EndoSuccess Apical Surgery Kit

SA-F00069

**\$747**



### PerfectMargin Shoulder Kit

SA-F00736

**\$686**



### PerfectMargin Rounded Kit

SA-F00738

**\$686**



### Excavus Kit

SA-F00739

**\$963**



### NEW Implant Protect Kit

SA-F02120

**\$1,396**



**100% Pure  
Titanium**

## EMS Scaler Handpiece

EM-EN-041



## PIEZON<sup>®</sup> NO PAIN handpiece

EM-EN-061



## PIEZON<sup>®</sup> NO PAIN LED handpiece

EM-EN-60



### EMS Scaling Tips



**A**

EM-DS-001

For removing supragingival deposits in all quadrants



**P**

EM-DS-011

For removing supra- and subgingival calculus in all quadrants



**PS**

EM-DS-016

For removing calculus in deep periodontal pockets in all quadrants



**B**

EM-DS-003A

For cleaning lingual surfaces with heavy stain and calculus



**C**

EM-DS-002A

For removing deposits and stain – especially suitable for removing bonding residue, (e.g. in orthodontics)

### EMS Scaler Handpiece Consumables



#### O-rings

EM-BC-077 Water O-Ring (base)



#### Cone Piece Seal

AB-348/A

### EMS Endo System Kits



#### Starter Kit FS-279

Refills (6)  
DT-069A

### EMS Implant Cleaning Kits



#### Starter Kit FS-295

Refills (4) DT-065A

### EMS Perio Kits



**PL1**

EM-DS-030

Left-curved instrument for periodontal debridement – especially suitable for difficult-to-reach interproximal surfaces



**PL2**

EM-DS-031

Same as PL1 instrument with a right curve



**PL3**

EM-DS-032

Instrument for cleaning and disinfecting periodontal pockets – especially suitable for follow-up and recall visits



**PL4**

EM-DS-030

Left-curved instrument with small ball (> 0.6-mm diameter) on instrument tip for the periodontal debridement of furcations and concavities



**PL5**

EM-DS-034

Same as PL4 instrument with right curve

## Implant Maintenance



**PI - Starter Kit**  
EM-FS-295

4 PI instruments, 1 file holder (120°) and  
1 flat wrench



**PI - Refill**  
EM-DT-065A

4 PI instruments

Ask us  
about other  
EMS  
products!

Call Us  
for Latest  
EMS  
Pricing

## EMS Endodontic Tips



**RT1**

EM-DS-066A

Diamond-tipped instrument  
for locating canals and  
removing calcifications in  
the coronal third of the root  
canal system



**RT2**

EM-DS-067A

Diamond-tipped instrument  
for removing ledges.  
Creates straight canal for  
easy viewing of broken  
instruments



**D**

EM-DS-005A

For loosening crowns,  
bridges and pins placed  
previously with phosphate  
cement



**H**

EM-DS-004A

For the lateral thermal  
condensation of gutta-  
percha



**Flat Wrench**

EM-DT-018

To change instruments for  
all three file holders



**180° File Holder**

EM-DS-069A

For use with RT3, Berutti  
and RE2 instruments

## Diamond Tipped Instruments



**HPL3**

EM-DS-075A

70µm grain

Diamond-tipped instruments for  
smoothing restoration overhangs



**DPL3**

EM-DS-065A

15µm grain

Diamond-tipped instruments for  
smoothing restoration overhangs

## EMS Endodontic Tips



**120° File Holder**

EM-DS-001A

For the flexibility to use  
different endo files,  
specially suited for anterior  
and premolar areas. Also  
suitable for RE2 and Berutti  
instruments



**90° File Holder**

EM-DS-012A

For the flexibility to use  
different endo files,  
specially suited for the  
molar area



**RT3**

EM-DT-062

Very long and fine  
instrument for the removal  
of broken instrument tips.  
Use with 180° file holder  
(5 pack)



**RE2**

EM-DT-061

Instrument for retrograde  
root canal isthmus  
preparation. The surface  
is coated with nonabrasive  
titanium nitride. Use with  
120° or 180° file holders  
(5 pack)



**Berruti Instrument**

EM-DT-060

Diamond-tipped instrument  
for the retrograde  
preparation of root  
canals. A tapered design  
allows minimally invasive  
access and therefore  
fewer postoperative  
complications. Use with  
120° or 180° file holders  
(5 pack)



**ESI - Starter Kit**

EM-FS-279

Non-cutting NiTi  
instrument for the  
effective cleaning and  
irrigation of the root canal  
system (6 files)



**ESI - Refill**

EM-DT-069A

Non-cutting NiTi instrument  
for the effective cleaning  
and irrigation of the root  
canal system (6 files)



**Endo K-Type File Set**

EM-DT-011

The root canal system (Use  
files in 90° or 120° file  
holders) K-Files for cleaning  
and disinfecting

**Endo K-Type Files**

ISO 15 White: EM-DT-006

ISO 20 Yellow: EM-DT-007

ISO 25 Red: EM-DT-008

ISO 30 Blue: EM-DT-009

ISO 35 Green: EM-DT-010







## AIR-N-GO easy

Convertible AIR-N-GO easy handpiece, a SUPRA nozzle, 1 intro kit of 20g bags of «CLASSIC» and «PEARL» powders, 1 maintenance kit (replacement o'rings, syringe of silicone grease with brushes, cannula, cleaning drill).

AIR-N-GO® easy with W&H adapter	SA-F10102	\$2,373
AIR-N-GO® easy with KaVo adapter	SA-F10100	\$2,373
AIR-N-GO® easy with Sirona adapter	SA-F10101	\$2,373
AIR-N-GO® easy with Bien-Air adapter	SA-F10103	\$2,373
AIR-N-GO® easy with Midwest adapter	SA-F10105	\$2,373

## AIR-N-GO easy Perio Kit

Includes:

- Perio tank
- Perio nozzle
- Perio powder bottle



**\$918**

SA-F10120

## AIR-N-GO easy Powder – 50 x 20g Satchels

Peppermint Flavoured Powder	SA-F10256	\$194
Lemon Flavoured Powder	SA-F10257	\$194
Raspberry Flavoured Powder	SA-F10258	\$194
Cola Flavoured Powder	SA-F10259	\$194
Neutral Flavoured Powder	SA-F10260	\$194
Pearl Powder	SA-F10263	\$194

## AIR-N-GO easy Powders (4 bottles x 250g)

Classic Powder – Neutral (SA-F10254)	\$174
Classic Powder – Natural Cola (SA-F10253)	\$174
Classic Powder – Natural Raspberry (SA-F1022)	\$174
Classic Powder – Peppermint Essential Oil (SA-F10250)	\$174
Classic Powder – Lemon Essential Oil (SA-F10251)	\$174
Pearl Powder – Neutral (SA-F10262)	\$256
Perio Powder – Neutral (3 bottles x 160g) (SA-F10270)	\$235

